

标准油路块 D07SPRV



型号说明

HY* D07 SP * * * / 10

A 铝 7A04 最高压力20.7MPa
D 钢 45# 最高压力31.5MPa

设计序列号

16通径

过渡块

RV 溢流阀P到T口

P,A,B,T油口螺纹				X,Y油口螺纹
12P	3/4"NPT(Z)	16P	1"NPT(Z)	1/4"NPT(Z)
12S	SAE-12	16S	SAE-16	SAE-6
12B	3/4"BSP(G)	16B	1"BSP(G)	1/4"BSP(G)
12M	M27X2	16M	M33X2	M14X1.5

溢流阀插件	
C	C-10-Z/油口12
	C-16-Z/油口16
S	T-3A/油口12
	T-16A/油口16

标准油路块 D07SPRV

外形尺寸

带溢流阀的过渡块

阀安装螺纹:美制 0.25-20 x 0.50 DP 和 0.38-16 x 0.75 DP

公制 M6-1.0mm ISO 6H x [12.7]DP 和 M10-1.5mm ISO 6H x [19.1] DP

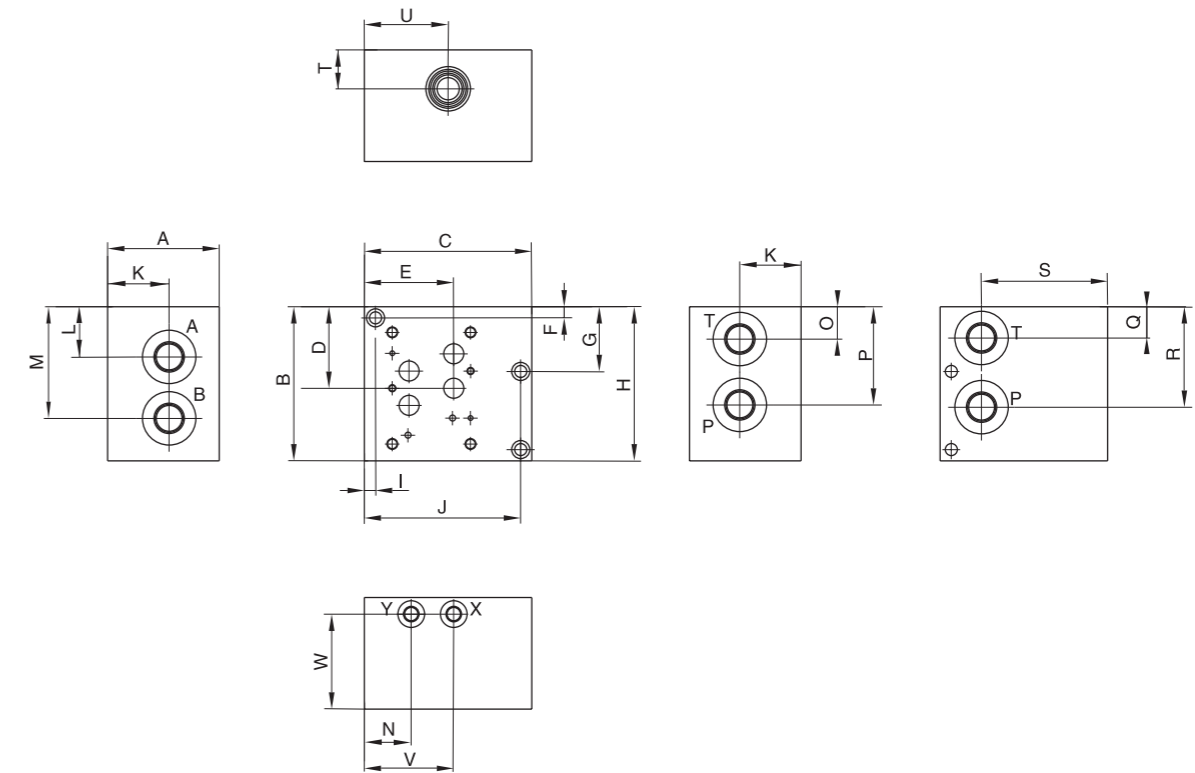
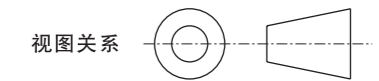

尺寸	A	B	C	D	E	F	G	H	I	J	K	L
D07SPRVC12	2.75 [69.9]	4.75 [120.7]	4.00 [101.6]	2.34 [59.4]	2.81 [71.4]	0.38 [9.5]	--	4.37 [111.0]	1.38 [35.1]	2.00 [50.8]	1.50 [38.1]	1.50 [38.1]
D07SPRVS12	2.50 [63.5]	4.75 [120.7]	4.00 [101.6]	2.34 [59.4]	2.81 [71.4]	0.38 [9.5]	--	4.37 [111.0]	1.38 [35.1]	2.00 [50.8]	1.25 [31.8]	1.50 [38.1]
D07SPRVC16	4.00 [101.6]	5.50 [139.7]	6.00 [152.4]	2.97 [75.4]	3.31 [84.2]	0.38 [9.5]	2.25 [57.2]	5.13 [130.2]	0.38 [9.5]	5.63 [142.9]	2.19 [55.6]	1.81 [46.0]
D07SPRVS16	4.00 [101.6]	5.50 [139.7]	6.00 [152.4]	2.97 [75.4]	3.31 [84.2]	0.38 [9.5]	2.25 [57.2]	5.13 [130.2]	0.38 [9.5]	5.63 [142.9]	2.19 [55.6]	1.81 [46.0]

尺寸	M	N	O	P	Q	R	S	T	U	V	W
D07SPRVC12	3.12 [79.2]	1.19 [30.2]	1.19 [30.2]	2.78 [70.6]	1.13 [28.6]	2.75 [69.9]	2.81 [71.4]	1.75 [44.5]	2.22 [56.4]	2.81 [71.4]	2.25 [57.2]
D07SPRVS12	3.12 [79.2]	1.19 [30.2]	1.19 [30.2]	2.78 [70.6]	1.13 [28.6]	2.75 [69.9]	2.81 [71.4]	1.25 [31.8]	2.31 [58.7]	2.81 [71.4]	2.00 [50.8]
D07SPRVC16	4.13 [104.8]	1.75 [44.5]	1.00 [25.4]	3.50 [88.9]	1.13 [28.6]	3.69 [93.7]	4.50 [114.3]	1.50 [38.1]	3.00 [76.2]	3.25 [82.6]	3.38 [85.7]
D07SPRVS16	4.13 [104.8]	1.75 [44.5]	1.13 [28.6]	3.50 [88.9]	1.13 [28.6]	3.69 [93.7]	4.50 [114.3]	1.50 [38.1]	3.00 [76.2]	3.25 [82.6]	3.38 [85.7]